

## Opening a MIDI File in Sibelius 5 – Export to Sibelius 5 from Pro Tools

When opening a MIDI file in Sibelius 5, you will be prompted with the following dialogue box:

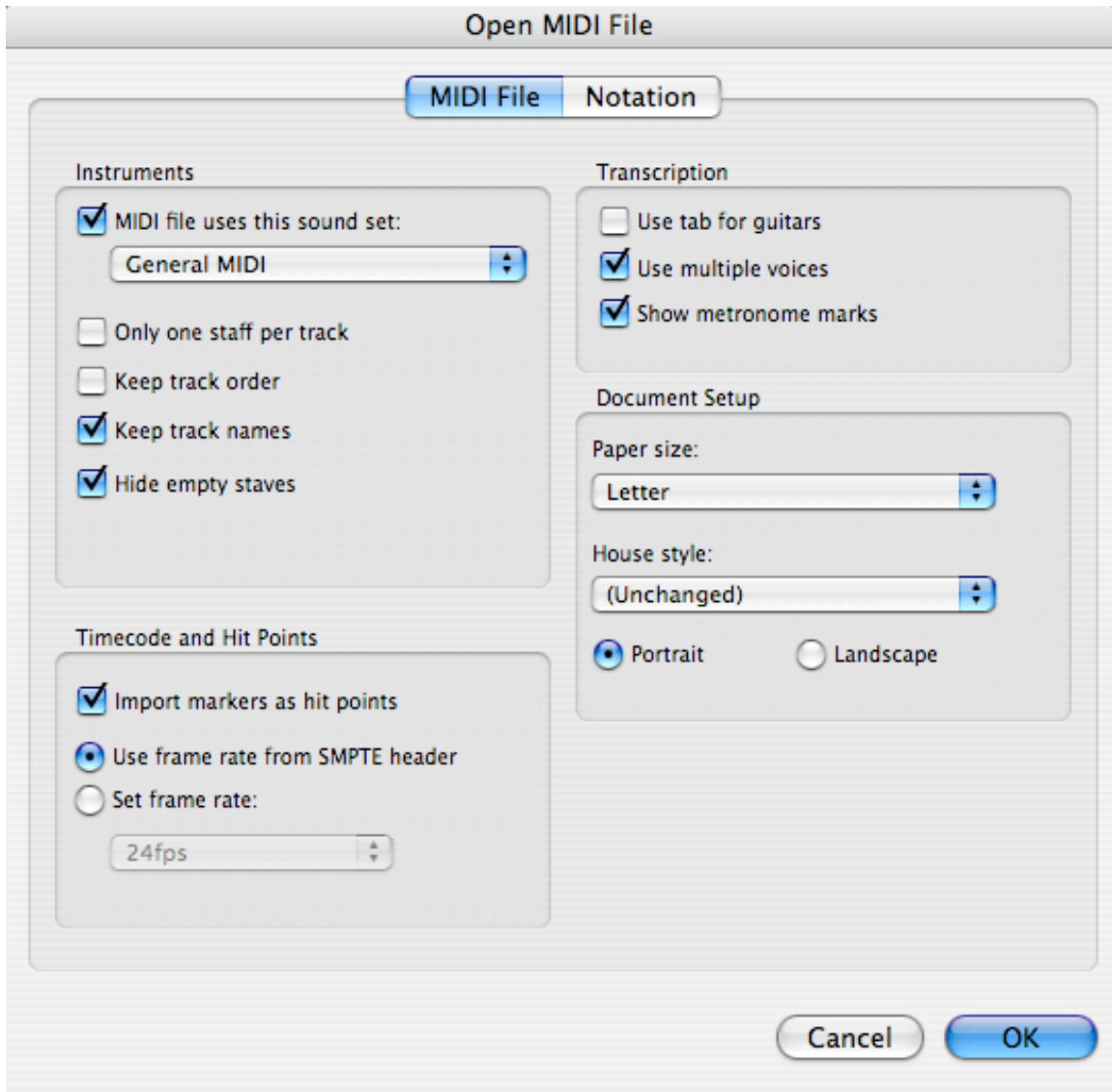

While most of this is self-explanatory, it might be worth pointing out a few key features:

1. “Only One Staff Per Track” – If one or more of the instruments being imported requires a grand staff (such as a piano/keyboard), then this box should probably *not* be checked.

2. “Keep Track Names” – Checking this box will ensure that Sibelius, to the best of its ability, maintains the text names for your instruments that you have typed in to your sequencer. If this is not checked, Sibelius will pick its own staff/track names for you, based on Sibelius’ own defined instruments. The difference is subtle and may look something like this:

Keep Track Names Checked

Keep Track Names Unchecked

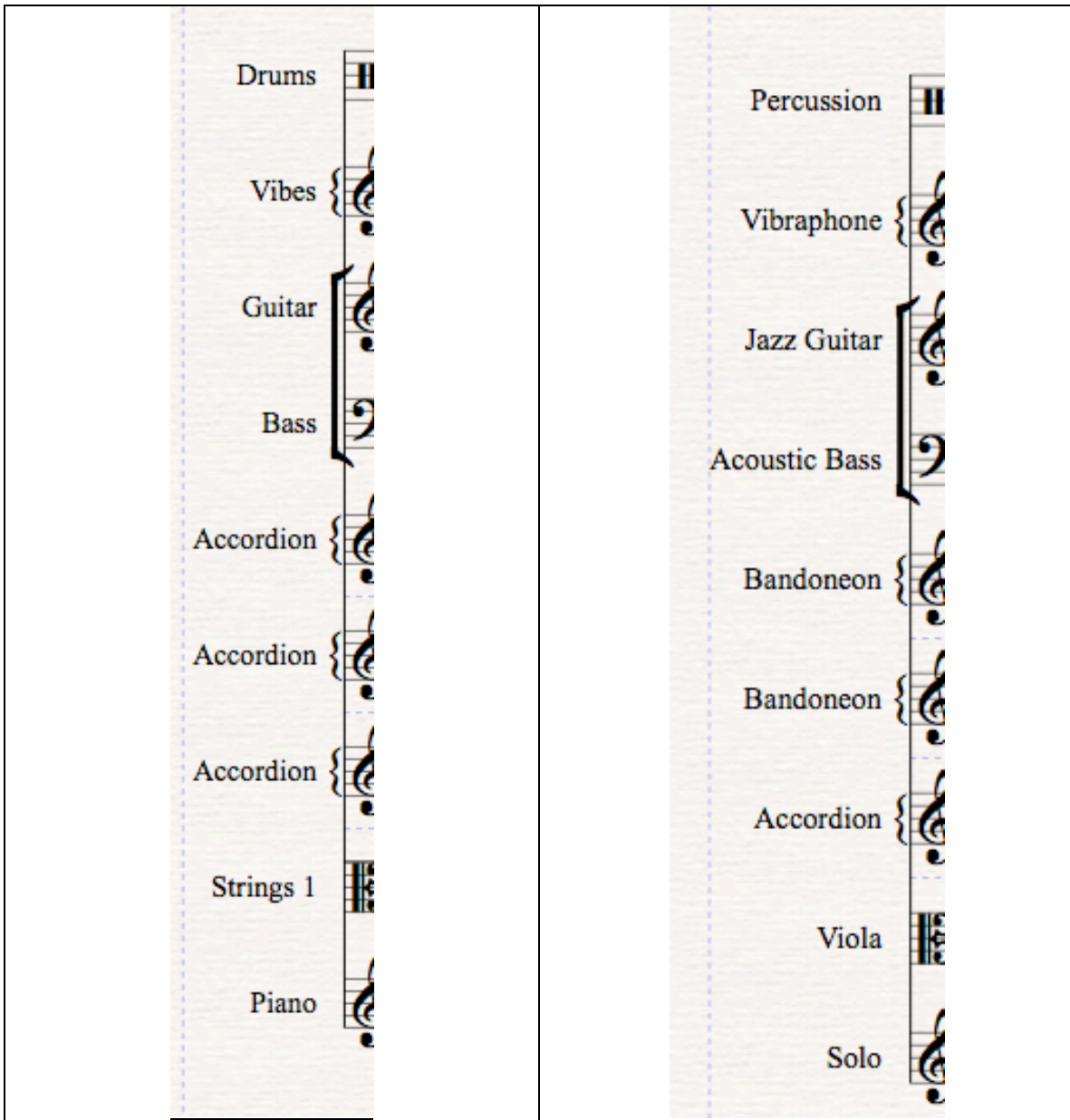

3. “Hide Empty Staves” – This is a view feature. If this box is checked, Sibelius will hide the staff of any instrument in any system where that instrument has no musical notes or material. In place of the hidden staves, you will see a dashed blue line, as in this example:



To turn this feature *off* once you are in Sibelius (to show the hidden staves):

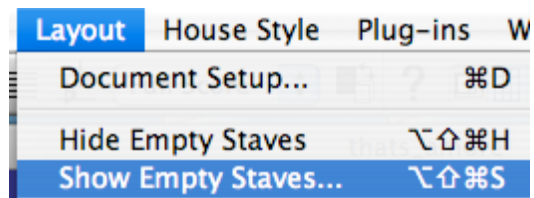

4. “Import Markers as Hit Points” – This feature should do just as it says, however in my experience, this hasn’t always been the case...
5. “Use Tab for Guitars” – If checked, Sibelius will give you a tablature staff, rather than a treble clef 5-line staff for any guitar track that is imported.
6. “Use Multiple Voices” – This will allow more than one “voice” per staff, meaning (in most cases), two lines of music (one with stems up, one with stems down) on the same staff, such as in this very hideous percussion import example:



This option is something to think about prior to import – Will you need it or not? Note that it is very easy with Sibelius’ “filter” feature to filter notes out later and send them into other voices, should you decide to not allow multiple voices on import. This is a file/score-specific feature. If a track specifically calls for multiple voices, then the check box should remain checked. If not, uncheck it. You can always fix it later.

## The “Notation” Tab of the “Open MIDI File” Dialogue:

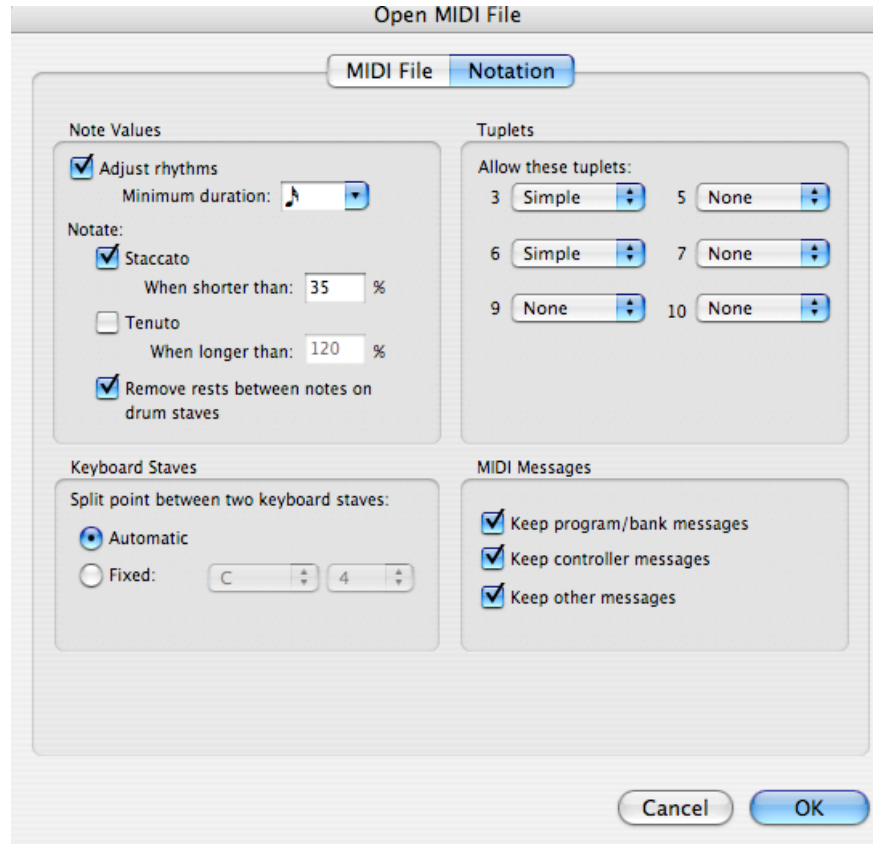

This is where you set up your MIDI import quantization settings, although note that Sibelius never calls it “Quantization” – They call it “Minimum Duration”

1. “Adjust Rhythms / Minimum Duration” – This drop-down menu allows the user to choose a minimum note value to quantize the music to. In general, I’ve gotten the best result by picking a value that is one step larger than my minimum note value. In other words, if the piece I am importing has mostly quarter notes and only a few 8<sup>th</sup> notes, I would actually choose the *quarter note* value here, rather than the 8<sup>th</sup> note value, and Sibelius will still give me a few 8<sup>th</sup> notes. Whereas, if I choose the 8<sup>th</sup> note value, I may end up with too many 8<sup>th</sup> notes, not enough quarter notes, and possibly even a few 16<sup>th</sup> notes.
2. “Staccato” / “Tenuto” – I suggest leaving these boxes *unchecked*, as they’re difficult to define, unless you know exactly what percentage you’ve played them in at. I think it’s easier to put them in correctly yourself (later), rather than having to correct possible mistakes Sibelius might make on its own.
3. “Remove Rests Between Notes on Drum Staves” – In general, it’s good to have this checked. The difference is obvious:

Unchecked:



Checked:



4. Keyboard Staves / “Split Point...” – Sibelius will either think of the best split point for your grand staff, based on the music in each bar, *or* you can set a pre-defined split point before importing.
5. “Allow Tuplets” – Decide whether or not you want to allow Sibelius to write tuplets. Again, this is score-specific. It’s best to not allow any tuplets unless you’re certain that there are tuplets, and if there are, it’s best to be very specific here in allowing only those tuplets that you’re sure are present in the music. This will increase the accuracy of your written rhythms... dramatically!
6. “MIDI Messages” – Sibelius will import and maintain any MIDI messages that are in your MIDI file, so long as you keep these boxes checked.